

Sketch 4: Axon Cube

Format: 11 x 17

Scale: 1/2"=1'-0"

Medium: pencil or pen

Due: October 1st for pin-up during class

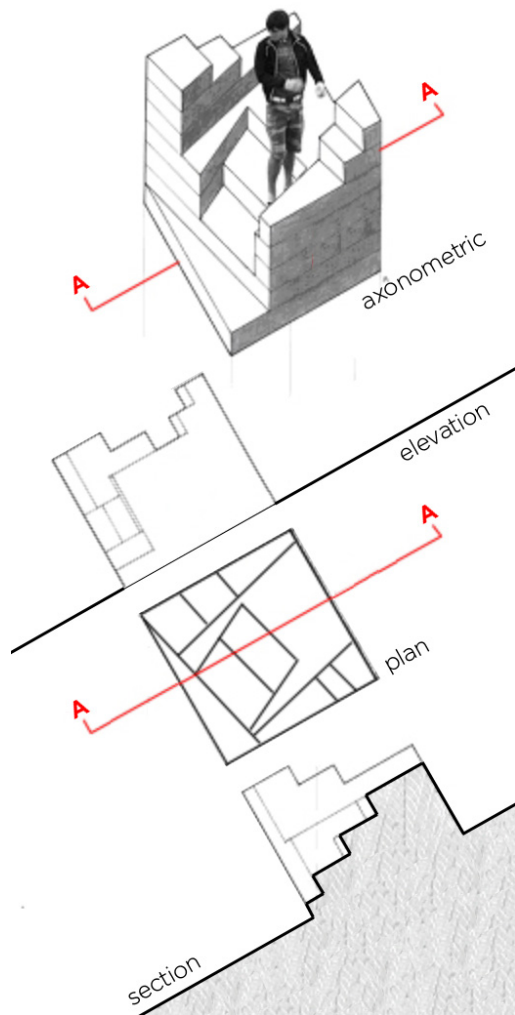

Begin by constructing a 5'x5'x5' cube, then carve away volume in order to design a stairway.

Stairway requirements:

Assume the cube is divided into seven equal horizontal layers and that each layer is the thickness of one stair riser.

The stairway itself consists of a minimum of four steps.

You must cut something away from every layer of the cube.

You may use non-orthogonal and curving shapes in the plan view only.

Present your design in the format illustrated above which includes the following views: One plan oblique oriented at 30-60; one plan, also oriented 30-60, one elevation and one section.

Do not show hidden lines in any of your views. Use lineweights to distinguish between different edge conditions: heavy lines for section cuts; medium for all else.