

Sketchup House Model Assignment 9:

HOUSE axons in Sketchup

due: November 19

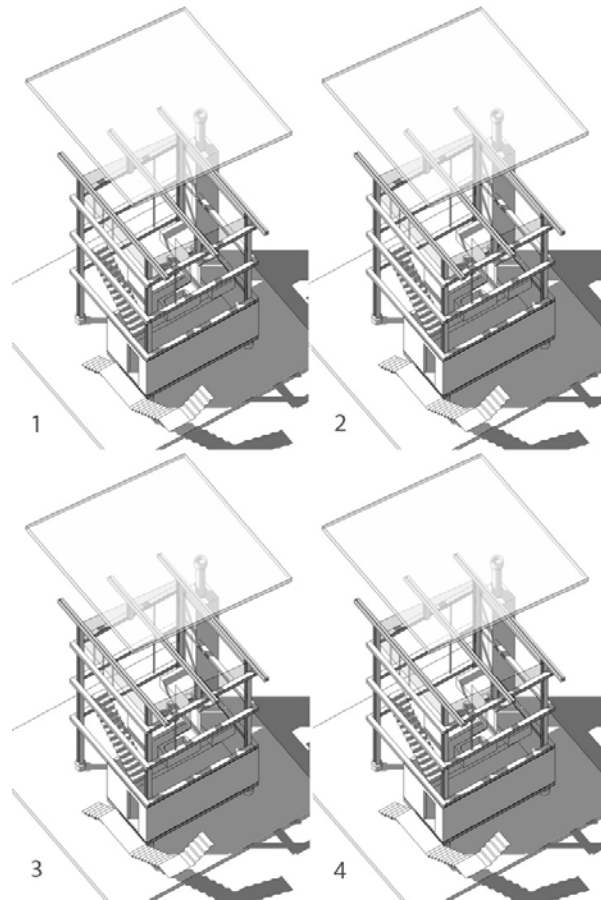

In Sketchup, carefully set up an axonometric view of your precedent house. Let this view serve as the basis of a four-diagram analysis. Use Pull-apart, x-ray, see-through and/or section cut techniques on the base axonometric so as to analyze:

Movement through the building, or **composition**: massing, additive/subtractive, base/middle/top, proportion, hierarchy, or **structure** (to) **enclosure** and **circulation** (to) **program**. Or sun angles, materiality, moving parts, public/private (zoning), fabrication process(es), or the construction process.

All told, four diagrams should explain or offer insight into some analytical interpretation of the building.

Save each Sketchup view as a two-dimensional image. Open the four views in Photoshop and arrange them so that they can be printed out on a single sheet of paper- approximately 24" x 36". Label and/or annotate each view. Print at 150 dpi or higher. Trim your sheet to fit your views. Print in black-and-white. You may further develop your presentation by hand, using graphite or other dry media.

Above is an example of a sheet layout.