

## Sketchup House Model Assignment 7

due November 5th

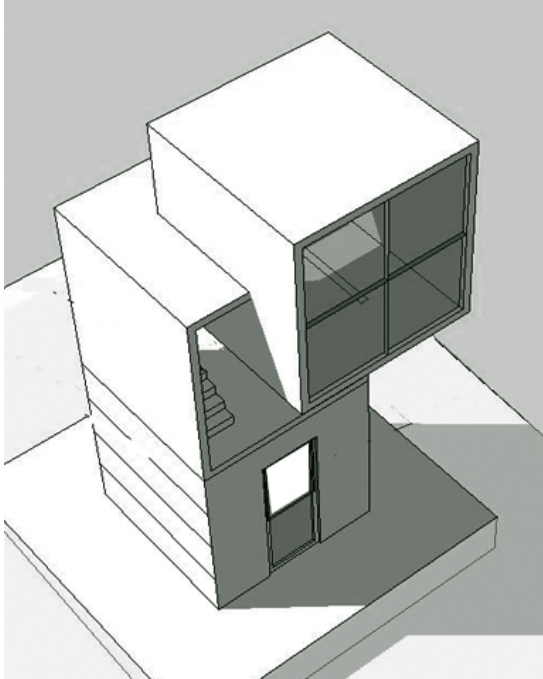

Carefully construct a 3D Sketchup model of your Arch 580 Precedent House.

Required in your Sketchup model:

- A model base for the house (about 2x to 4x the size of the house's footprint)
- Exterior and interior walls, roofs, floors, and stairs
- Counters and cabinets in the kitchen and bathrooms (appropriately abstracted)
- Major built-ins
- Windows with mullions- abstracted where appropriate

Do not:

- Include textures- use only muted colors and subtle transparencies
- Use colors from the Sketchup materials catalogue- e.g. no Sketchup blue glass
- Model or include railings, trees or people

Format:

Upload your Sketchup model (your .skp file) to your Arch 580 "Assignment 7: Sketchup Model of Precedent House" folder at UWM's D2L site. Your file should be in this folder by the beginning of the class on Friday the 5th.

Grading Criteria:

Your model must include all required elements.